



Oak Harbor Retrofit

Deep Energy Retrofit with Retrofit Insulated Panels

Location:

Oak Harbor, WA

Size:

2,908 sq. ft.

Builder:

CVH, Inc.,
DBA Clifton View Homes

Retrofit Panel Provider:

Premier SIPs

Total Reduction in Energy Use:

64%

HERS Index:

74

Energy savings per year:

\$3,060

Air infiltration before:

15.3 ACH50

Air infiltration after:

5.25 ACH50



Oak Harbor home before retrofit

After purchasing an aging house with spectacular views of Washington's Skagit Bay, the Johnsons contracted Clifton View Homes to conduct a complete remodel, making their home more energy-efficient in the process. The builder installed 9-foot-tall retrofit insulated panels over the exterior walls and rim joist, establishing a complete air barrier. Along with additional attic insulation, floor insulation and new windows, retrofit insulated panels helped cut energy use by a staggering 64 percent.

Energy-Efficient Features

- R-14 retrofit insulated wall panels, R-11 cavity insulation
- R-38 attic insulation (total)
- R-30 floor insulation (total)
- Low-E, U-0.28 windows
- Whole-house air sealing
- Two ductless mini-split air source heat pump, 9.0 HSPF
- 0.91 EF electric water heating
- New ENERGY STAR appliances

Retrofit detail

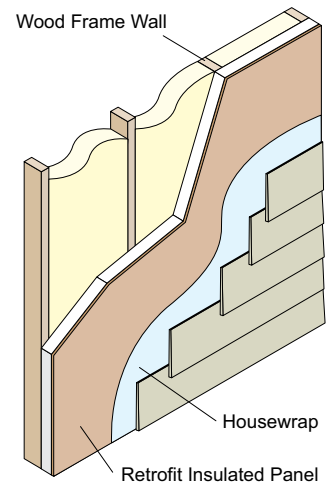

**Structural Insulated
Panel Association**

www.sips.org
P.O. Box 39848, Fort Lauderdale FL 33339
p: 253.858.7472

Copyright © 2013 Structural Insulated Panel Association (SIPA). All rights reserved.